

Site Name EXISTING PHOTOMETRIC PLAN

SCALE: NTS

CITY, STATE

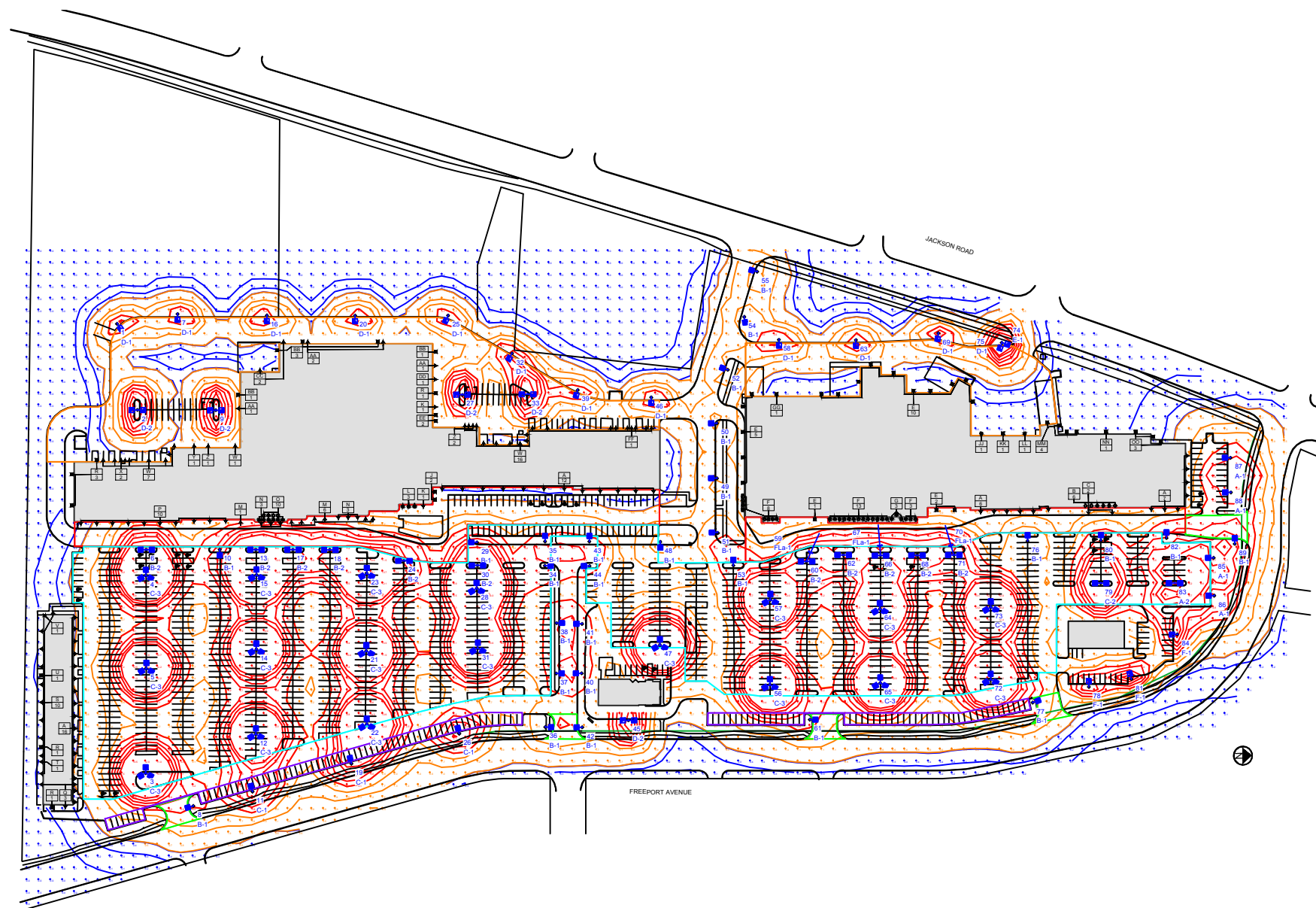

Calculation Summary							
Label	Avg	Max	Min	Avg/Min	Max/Min	# Pts	%PtsRange
All Calculation Points	2.64	20.8	0.0	N.A.	N.A.	3969	N.A.
Back of Building North	0.90	6.1	0.0	N.A.	N.A.	128	N.A.
Back of Building South	1.74	9.5	0.0	N.A.	N.A.	293	N.A.
Entry & Exit Lower left	2.84	3.3	2.2	1.29	1.50	5	N.A.
Entry & Exit Lower Left Center	2.90	3.1	2.7	1.07	1.15	4	N.A.
Entry & Exit Lower Right	1.98	2.6	1.3	1.52	2.00	4	N.A.
Entry & Exit Lower Right Center	2.22	2.8	1.5	1.48	1.87	5	N.A.
Entry & Exit Right (North)	4.30	5.5	3.2	1.34	1.72	10	N.A.
Main Drive North	2.04	5.3	0.5	4.08	10.60	86	N.A.
Main Drive South	2.20	9.5	0.2	11.00	47.50	150	N.A.
Main Parking	5.44	20.8	0.4	13.60	52.00	1195	66.0
Perimeter Parking North	3.17	5.6	0.9	3.52	6.22	27	N.A.
Perimeter Parking South	3.91	10.3	0.9	4.34	11.44	35	N.A.

Luminaire Schedule							
Symbol	Qty	Label	Arrangement	TLL	LLF	Description	BUG Rating
	4	A-1	SINGLE	130000	0.50	Existing Fixt 1000W HPS T5 Vert FG 36'-4 Mtg Ht	B5-U3-G5
	1	A-2	BACK-BACK	130000	0.50	Existing Fixt 1000W HPS T5 Vert FG 36'-4 Mtg Ht	B5-U3-G5
	27	B-1	SINGLE	50000	0.50	Existing Fixt 400W T5 HPS Vert SG 25'-6 Mtg Ht	B5-U3-G4
	11	B-2	BACK-BACK	50000	0.50	Existing Fixt 400W T5 HPS Vert SG 25'-6 Mtg Ht	B5-U3-G4
	3	C-1	SINGLE	130000	0.50	Existing Fixt 1000W HPS Horiz FG 40'-8 Mtg Ht	B5-U0-G5
	1	C-2	BACK-BACK	130000	0.50	Existing Fixt 1000W HPS Horiz FG 40'-8 Mtg Ht	B5-U0-G5
	18	C-3	3 @ 120 DEGREES	130000	0.50	Existing Fixt 1000W HPS Horiz FG 40'-8 Mtg Ht	B5-U0-G5
	12	D-1	SINGLE	50000	0.50	Existing Fixt 400W T3 HPS Horiz FG 26'-1' Mtg Ht	B4-U0-G4
	5	D-2	BACK-BACK	50000	0.50	Existing Fixt 400W T3 HPS Horiz FG 26'-1' Mtg Ht	B4-U0-G4
	1	E-1	SINGLE	50000	0.50	Exist Fixt 400W HPS T2 Horiz FG 26'-1 Mtg Ht	B5-U0-G4
	3	F-1	SINGLE	50000	0.50	Existing Fixt 400W T3 HPS Horiz FG 20'-9' Mtg Ht	B4-U0-G4
	3	FLA-1	SINGLE	16000	0.50	Exist Flood Fixt 150W HPS Vert FG 21'-0 Mtg Ht	B3-U0-G0

Total Points	% of Points Met in Main Parking
1195	66%

COLOR CODE FOR DL2	
RED	3.00 +
TAN	0.50 - 2.99
BLUE	0.00 - 0.49

BASED ON THE INFORMATION PROVIDED, ALL DIMENSIONS AND LUMINAIRE LOCATIONS SHOWN REPRESENT RECOMMENDED POSITIONS. THE ENGINEER AND/OR ARCHITECT MUST DETERMINE APPLICABILITY OF THE LAYOUT TO EXISTING OR FUTURE FIELD CONDITIONS.

THE LIGHTING PATTERN REPRESENTS ILLUMINATION LEVELS CALCULATED FROM LABORATORY DATA TAKEN UNDER THE CONTROLLED CONDITIONS UTILIZING CURRENT INDUSTRY STANDARD LAMP RATINGS IN ACCORDANCE WITH ILLUMINATING ENGINEERING SOCIETY APPROVED METHODS. ACTUAL PERFORMANCE OF ANY MANUFACTURER'S LUMINAIRE MAY VARY DUE TO VARIATION IN ELECTRICAL VOLTAGE, TOLERANCE IN LAMPS, AND OTHER VARIABLE FIELD CONDITIONS.

FOR ADDITIONAL LIGHTING INFORMATION CONTACT:
On-Site Lighting & Survey, LLC
 PH: 763.684.1548

COMPANY INFO
 1111 HIGHWAY 25 NORTH
 SUITE 201
 BUFFALO MN 55313
 PH:763.684.1548
 FAX:763.682.9048

PROJECT INFO
 SITE NAME
 ADDRESS

ENGINEER INFO
 ENGINEER SEAL

#	DATE	INIT	DESCRIPTION

REVISIONS

SHEET DESCRIPTION
EXISTING PHOTOMETRIC PLAN

PROJECT #
BU

DESIGN ISSUE LEVEL DATE
 10.04.2017
2

AGI
C.D.HEANER

CAD
C.D.HEANER

SHEET #:
SL100

REV #:
0

SITE NAME CENTER LED PHOTOMETRIC PLAN

SCALE: NTS

CITY, STATE

On-Site Lighting & Survey, LLC

1111 HIGHWAY 25 NORTH
SUITE 201
BUFFALO MN 55313
PH:763.684.1548
FAX:763.682.9048

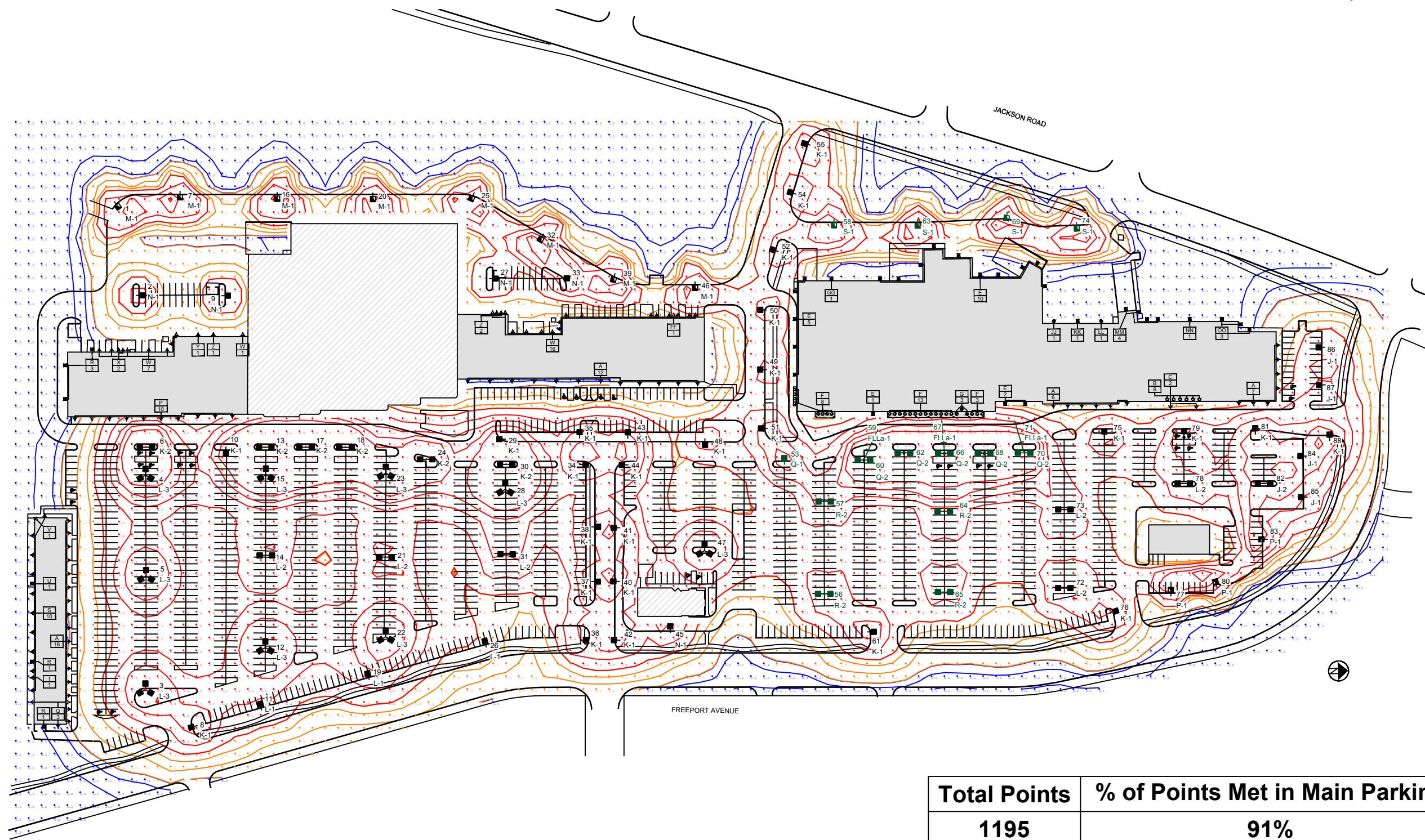

Total Points	% of Points Met in Main Parking
1195	91%

COLOR CODE FOR DL2	
RED	2.00 +
TAN	0.50 - 1.99
BLUE	0.00 - 0.49

BASED ON THE INFORMATION PROVIDED, ALL DIMENSIONS AND LUMINAIRE LOCATIONS SHOWN REPRESENT RECOMMENDED POSITIONS. THE ENGINEER AND/OR ARCHITECT MUST DETERMINE APPLICABILITY OF THE LAYOUT TO EXISTING OR FUTURE FIELD CONDITIONS.

THE LIGHTING PATTERN REPRESENTS ILLUMINATION LEVELS CALCULATED FROM LABORATORY DATA TAKEN UNDER THE CONTROLLED CONDITIONS UTILIZING CURRENT INDUSTRY STANDARD LAMP RATINGS IN ACCORDANCE WITH ILLUMINATING ENGINEERING SOCIETY APPROVED METHODS. ACTUAL PERFORMANCE OF ANY MANUFACTURER'S LUMINAIRE MAY VARY DUE TO VARIATION IN ELECTRICAL VOLTAGE, TOLERANCE IN LAMPS, AND OTHER VARIABLE FIELD CONDITIONS.

FOR ADDITIONAL LIGHTING INFORMATION CONTACT:
On-Site Lighting & Survey, LLC
PH: 763.684.1548

COMPANY INFO	1111 HIGHWAY 25 NORTH SUITE 201 BUFFALO MN 55313 PH:763.684.1548 FAX:763.682.9048			
PROJECT INFO	SITE NAME			
	ADDRESS			
ENGINEER INFO				
ENGINEER SEAL				
REVISIONS	#	DATE	INIT	DESCRIPTION
	1	11.07.2017	ZPN	FIX BUILDING MOUNT COUNT
2	01.23.2018	ZPN	UPDATE SCOPE	
SHEET DESCRIPTION	LED PHOTOMETRIC PLAN			

PROJECT #	BU4194
DESIGN LEVEL	10.17.2017
AGI	2
CAD	C.D.HEANER
SHEET #	C.D.HEANER
REV #	SL300 2

LED PHOTOMETRIC PLAN

SCALE: NTS

CITY, STATE

1111 HIGHWAY 25 NORTH
SUITE 201
BUFFALO MN 55313
PH:763.684.1548
FAX:763.682.9048

SITE NAME

ADDRESS

Luminaire Schedule						
Symbol	Qty	Label	Arrangement	LLF	Description	BUG Rating
	3	FLLa-1	SINGLE	0.90	New Cub Foods Cont. Flood 73W LED 7x5 21' Mtg Ht (5000K/32 LEDs/8193 Lumens/700mA) Visionaire VSF-1-7X5-32LC-7-5K	B2-U0-G1
	4	J-1	SINGLE	0.90	New Fixt 318W LED T5W 36'-4 Mtg Ht (5000K/35268 Lumens/VHO) LSI Industries Mirada XALM-5W-LED-VHO-50	B5-U0-G4
	1	J-2	BACK-BACK	0.90	New Fixt 318W LED T5W 36'-4 Mtg Ht (5000K/35268 Lumens/VHO) LSI Industries Mirada XALM-5W-LED-VHO-50	B5-U0-G4
	26	K-1	SINGLE	0.90	New Fixt 244W LED T5W 25'-6 Mtg Ht (5000K/29095 Lumens/HO) LSI Industries Mirada XALM-5W-LED-HO-50	B5-U0-G3
	6	K-2	BACK-BACK	0.90	New Fixt 244W LED T5W 25'-6 Mtg Ht (5000K/29095 Lumens/HO) LSI Industries Mirada XALM-5W-LED-HO-50	B5-U0-G3
	3	L-1	SINGLE	0.90	New Fixt 318W LED T5W 40'-8 Mtg Ht (5000K/35268 Lumens/VHO) LSI Industries Mirada XALM-5W-LED-VHO-50	B5-U0-G4
	6	L-2	BACK-BACK	0.90	New Fixt 318W LED T5W 40'-8 Mtg Ht (5000K/35268 Lumens/VHO) LSI Industries Mirada XALM-5W-LED-VHO-50	B5-U0-G4
	9	L-3	3 @ 120 DEGREES	0.90	New Fixt 318W LED T5W 40'-8 Mtg Ht (5000K/35268 Lumens/VHO) LSI Industries Mirada XALM-5W-LED-VHO-50	B5-U0-G4
	8	M-1	SINGLE	0.90	New Fixt 241W LED T3 26'-1 Mtg Ht (5000K/28667 Lumens/HO) LSI Industries MiradaXALM-3-LED-HO-50	B3-U0-G4
	5	N-1	SINGLE	0.90	New Fixt 244W LED T5W 26'-1 Mtg Ht (5000K/29095 Lumens/HO) LSI Industries XALM-5W-LED-HO-50	B5-U0-G3
	3	P-1	SINGLE	0.90	New Fixt 154W LED T3 20'-1 Mtg Ht (5000K/18874 Lumens/SS) LSI Industries XALM-3-LED-SS-50	B2-U0-G3
	1	Q-1	SINGLE	0.90	New Cub Foods Cont. Fixt 244W LED T5W 25'-6 Mtg Ht (5000K/29095 Lumens/HO) LSI Industries Mirada XALM-5W-LED-HO-5	B5-U0-G3
	5	Q-2	BACK-BACK	0.90	New Cub Foods Cont. Fixt 244W LED T5W 25'-6 Mtg Ht (5000K/29095 Lumens/HO) LSI Industries Mirada XALM-5W-LED-HO-5	B5-U0-G3
	4	R-2	BACK-BACK	0.90	New Cub Foods Cont. Fixt 318W LED T5W 40'-8 Mtg Ht (5000K/35268 Lumens/VHO) LSI Industries Mirada XALM-5W-LED-VHO	B5-U0-G4
	4	S-1	SINGLE	0.90	New Cub Foods Cont. Fixt 241W LED T3 26'-1 Mtg Ht (5000K/28667 Lumens/HO) LSI Industries MiradaXALM-3-LED-HO-50	B3-U0-G4

Calculation Summary							
Label	Avg	Max	Min	Avg/Min	Max/Min	# Pts	%PtsRange
All Calculation Points	2.16	12.6	0.0	N.A.	N.A.	3969	N.A.
Back of Building North	1.47	4.9	0.0	N.A.	N.A.	128	N.A.
Back of Building South	1.86	6.1	0.0	N.A.	N.A.	293	N.A.
Entry & Exit Lower left	3.34	4.1	2.4	1.39	1.71	5	N.A.
Entry & Exit Lower Left Center	4.13	4.3	3.9	1.06	1.10	4	N.A.
Entry & Exit Lower Right	2.40	3.2	1.7	1.41	1.88	4	N.A.
Entry & Exit Lower Right Center	2.94	4.0	2.2	1.34	1.82	5	N.A.
Entry & Exit Right (North)	4.26	5.7	3.5	1.22	1.63	10	N.A.
Main Drive North	2.94	6.2	1.0	2.94	6.20	86	N.A.
Main Drive South	3.05	10.1	0.2	15.25	50.50	150	N.A.
Main Parking	3.77	12.6	0.6	6.28	21.00	1195	90.7
Perimeter Parking North	2.14	4.4	0.9	2.38	4.89	27	N.A.
Perimeter Parking South	2.50	4.9	1.1	2.27	4.45	35	N.A.

COLOR CODE FOR DL2	
RED	2.00 +
TAN	0.50 - 1.99
BLUE	0.00 - 0.49

BASED ON THE INFORMATION PROVIDED, ALL DIMENSIONS AND LUMINAIRE LOCATIONS SHOWN REPRESENT RECOMMENDED POSITIONS. THE ENGINEER AND/OR ARCHITECT MUST DETERMINE APPLICABILITY OF THE LAYOUT TO EXISTING OR FUTURE FIELD CONDITIONS.

THE LIGHTING PATTERN REPRESENTS ILLUMINATION LEVELS CALCULATED FROM LABORATORY DATA TAKEN UNDER THE CONTROLLED CONDITIONS UTILIZING CURRENT INDUSTRY STANDARD LAMP RATINGS IN ACCORDANCE WITH ILLUMINATING ENGINEERING SOCIETY APPROVED METHODS. ACTUAL PERFORMANCE OF ANY MANUFACTURER'S LUMINAIRE MAY VARY DUE TO VARIATION IN ELECTRICAL VOLTAGE, TOLERANCE IN LAMPS, AND OTHER VARIABLE FIELD CONDITIONS.

FOR ADDITIONAL LIGHTING INFORMATION CONTACT:

On-Site Lighting & Survey, LLC
PH: 763.684.1548

#	DATE	INIT	DESCRIPTION
1	11.07.2017	ZPN	FIX BUILDING MOUNT COUNT
2	01.23.2018	ZPN	UPDATE SCOPE

LED PHOTOMETRIC PLAN

PROJECT # BU4194

DESIGN ISSUE DATE	10.17.2017
LEVEL	2
AGI	C.D.HEANER
CAD	C.D.HEANER
SHEET #:	SL301
REV #:	2